

'S' SERIES Frame 600

Frame Reference SDT600

Motors manufactured to STEBON 'S' Series frame 600 are available in two basic enclosures:

- SDT motors have a terminal box incorporated into the NDE bracket. The standard enclosure is to IP44. An alternative enclosure is IP54 rated.

Specification

- Hybrid design.
- 1.8° Step angle (200 steps per rev).
- 2-phase winding for use with bi-polar drives only.
- Class B insulation to IEC 60085 and BS2757.
- NEMA Size 23.
- Bearing loading, axial, 70N max.
- Bearing loading, radial, 120N max.



Ratings

Frame reference	Maximum Holding Torque	Maximum Detent Torque	Bipolar Amps per phase	Resistance per phase	Inductance per phase	Rotor Inertia	Weight
	Ncm	Ncm	Amps	Ohms	mH	kgcm ²	kg
SDT601-3000-11	33	2.5	1.1	3.00	6.0	0,06	0,34
SDT601-750-21	33	2.5	2.1	0.75	1.5	0.06	0.34
SDT602-2500-14	64	3.5	1.4	2.50	8.0	0.12	0.50
SDT602-550-30	64	3.5	3.0	0.55	1.7	0.12	0.50
SDT602-125-64	64	3.5	6.4	0.12	0.5	0.12	0.50
SDT603-4400-13	109	7.0	1.3	3.60	13.2	0.20	0.70
SDT603-1100-27	109	7.0	2.7	0.90	3.3	0.20	0.70
SDT603-185-66	109	7.0	6.6	0.17	0.5	0.20	0.70
SDT604-2200-21	145	10.0	2.1	2.40	9.6	0.33	1.20
SDT604-550-41	145	10.0	4.1	0.60	2.4	0.33	1.20
SDT604-240-65	145	10.0	6.5	0.25	0.9	0.33	1.20

Dimensions (mm)

SDT

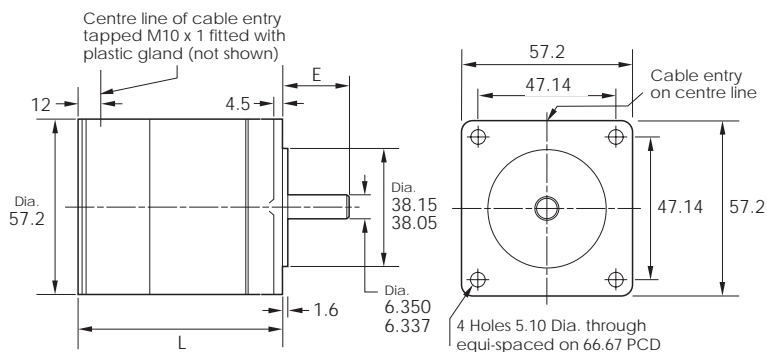

Frame size	L	L	E	E
	(IP44)	(IP54)	(IP44)	(IP54)
SDT601	60	64	20.6	17.1
SDT602	72	76	20.6	17.1
SDT603	87	91	20.6	17.1
SDT604	123	127	20.6	17.1