

STEBON ENCODER MOTORS

Pulse Tracking and Encoder Following

STEBON encoder motors incorporate a high resolution optical encoder mounted into the terminal housing of the motor. This ensures that the encoder is protected to the same IP rating as the motor. Encoder resolution covers the range 100 to 2500 ppr. Encoder outputs are two-phase quadrature with a marker pulse and are compatible to EIA

standard RS422. Electrical connections to both the motor and encoder are via separate plug and socket. STEBON also manufacture an OEM option, where the encoder is mounted directly on the back of the standard flying lead or terminal box motor. Encoder lead length is 2m.



Encoder Specification

Input voltage range	5 to 24V (see output circuit)
Regulation, for 5V operation	5% with 2% max ripple
Current consumption	100mA typical
Output circuits	See diagram
Frequency response	125kHz
Operating temperature	0°C – 70°C

5 to 24V Line driver

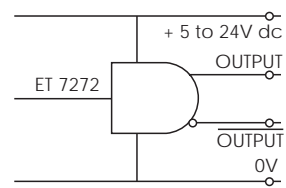

Dimensions (mm)

OEM Encoder motor – flying lead version (Frames 600 and 850 only)

Drawing shows Frame 600 version. Other dimensions as FDL type shown on Pages 4, 5 & 7

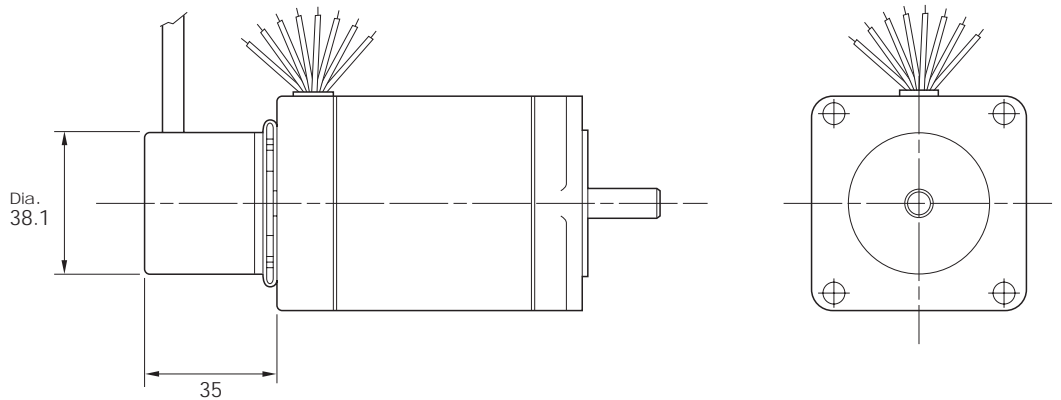

OEM Encoder motor – terminal box version (Not Frame 600)

Drawing shows Frame 800 version. Other dimensions as FDT type shown on Pages 7 & 8

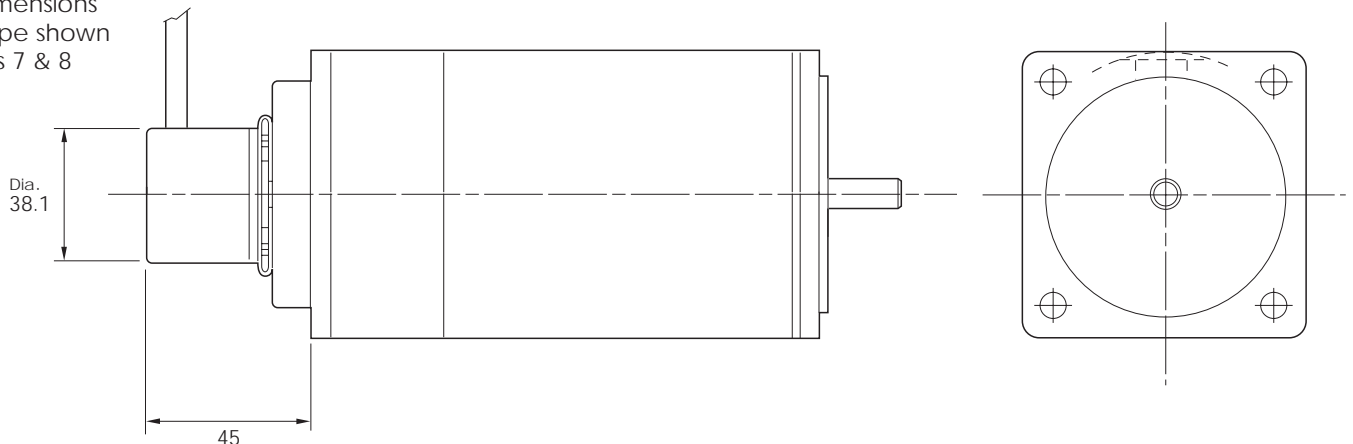

STEBON ENCODER MOTORS

Dimensions (mm)

Enclosed encoder motor

Dimensions are as standard SDT types except as modified in tables

Frame T850

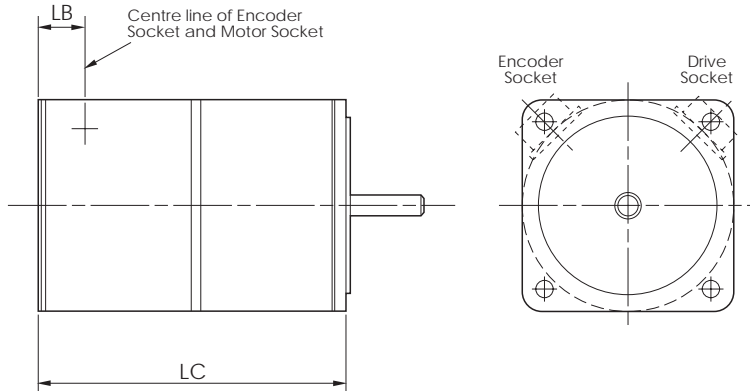

Frame size	LC	LB
851	129	18.5
852	162	18.5
853	194	18.5

Frame T1100

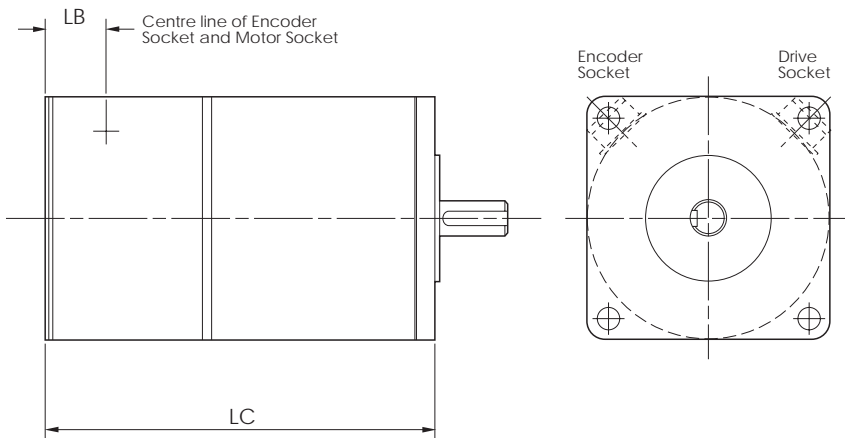

Frame size	LC	LB
1101	166	18.5
1102	219	18.5
1103	277	18.5